



1200 Rt. 130, Robbinsville, NJ 08691
(609) 490-0022 Fax (609) 426-1230
Email: info@InspectorEducation.com
www.InspectorEducation.com

***Earn 8 CEU's for your license renewal
and broaden your knowledge***

Building Envelope Performance Seminar Siding Inspections Made Easy

Date: *Tuesday, April 7, 2009 (just before the ALPHI meeting)*
Location: *The Westwood, Garwood, NJ*
Cost: *\$150.00 (includes course material and lunch)*
Time: *8 am to 5 pm*

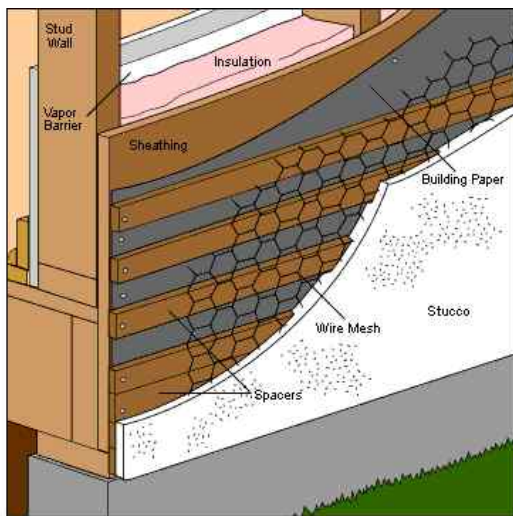

The building envelope and wall cladding should be designed to withstand moisture penetration to the interior, yet allow interior moisture to escape to the outside. Learn the proper installation of different building envelope systems and materials such as brick, stucco and EIFS. Do you know what the vented rain screen principle is? This course will also discuss inspection techniques, report writing strategies, life expectancies and more.

**To register call (609) 490-0022 or
visit our website at www.InspectorEducation.com**

Refund Policy: BICI reserves the right to cancel any class or seminar due to insufficient enrollment. A full refund will be issued when a class is canceled by BICI. If your schedule changes, you may attend a different seminar or send a substitute at no charge. Cancellations received prior to 10 days before the seminar will receive a refund, less a \$25 processing fee. No refunds if canceling within 10 days of seminar.